



Vacuum limiters are used to ensure that the side channel blower transports air the whole time. The air is used to cool the side channel blower inside.

At the same time the vacuum limiter ensures that the side channel blower do not use too much power. The number of vacuum limiters is matched by the capacity and the operating point of the side channel blower.

Vacuum limiters may only be used in frost-free and clean environments, since the air used for relief passes directly through the side channel blower.

Type	Order no.	d	b	Dimension [Pa]	Max. theoretical air volumen [m³/h]
VRL6	08 076 100	2"	175	0-60000	1000
VRL8	08 076 125	3"	190	0-60000	2200

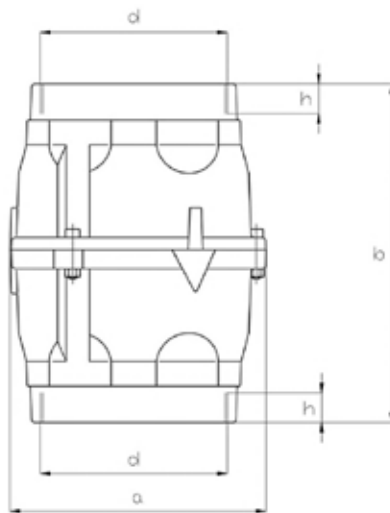

Type	DN	d	a	b	h	Weight [kg]
VRL6	50	G 2"	102	175	12	0.85
VRL8	80	G 3"	135	190	15	1.90

